

Layout Plan

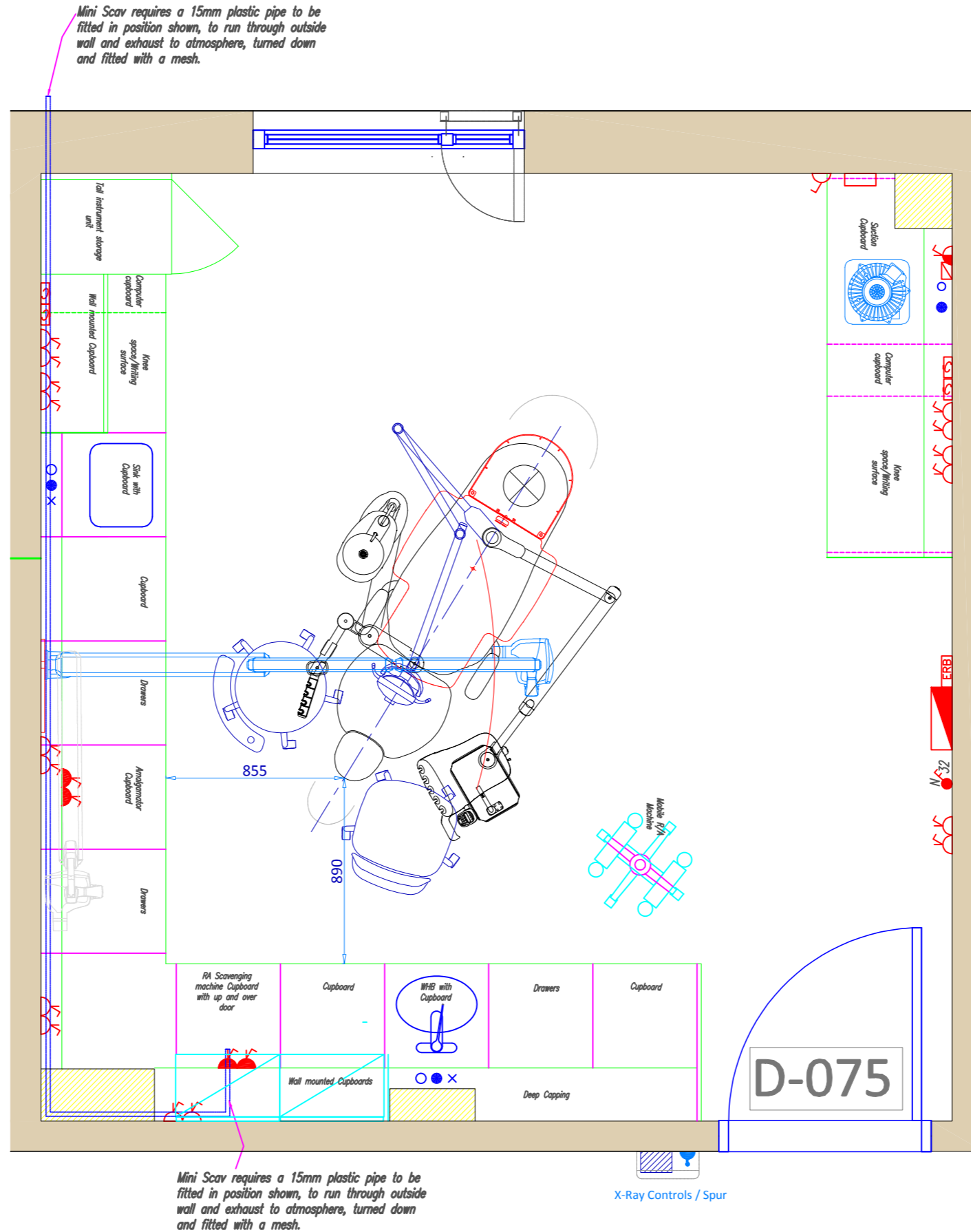

EQUIPMENT INDICATED:

- Adec 300RS Chair Package.
- Durr VSA300s suction motor.
- Kavo Focus wall mounted x-ray, 900mm arm - 2160mm reach.
- Intrafit cabinetry as shown.

Revision Details A - Updated the room sizes.	Date 09.04.19
---	------------------

Customer / Project
NHS Lothian
Blackburn Partnership Centre
Equipment Manager
Neil Worrall

Scale 1:25 @ A3

Creation Date 26.03.19

Project No.: WHG2419 D075	Revision: A
------------------------------	----------------

LAYOUT / POSITIONS APPROVED BY:
DATE: ___/___/___

Customer Name (PRINT)	Customer Signature
-----------------------	--------------------



Service Plan

NOTE: Remember to discuss the position of the isolating valves for the air & water supplies to this room. The valves must be positioned in an easily accessible position.

IMPORTANT NOTES TO CUSTOMER / CONTRACTOR:

CABINETS (if applicable):
The provision of, and connection to, services for sinks, taps and electric sockets within the cabinets would need to be carried out by the appointed PLUMBING AND ELECTRICAL CONTRACTORS. The exact service positions will be annotated on the service drawing provided by Wrights and/or their appointed Cabinetry Supplier. Wrights cannot be held liable if services are positioned incorrectly and cabinetry installations are delayed as a result.

POWER:
When a power supply is less than 1.5mtrs away from a water supply an R.C.D. (residual current device) must be fitted.

ISOLATION:
The mechanical services contractor must ensure that the water and air supplies to each individual surgery can be isolated to enable the dentist to turn off the water & air supplies at the end of surgery hours. These isolation valves must be fitted in an easily accessible position. It is also the responsibility of the mechanical services contractor to supply & fit the relevant parts for this isolation.

COMPRESSED AIR:
The air lines should be run in 15mm copper piping. An air/water separator should be fitted in line at the pipe entry point into the surgery. The pipe should then be lagged from the air/water separator to the pipe termination point. Adequate earth bonding will be required to the floor box. Wrights will not accept any responsibility for inadequate pipe work being used.

SUCTION & WASTE:
All waste & Suction pipe work to be no less than 40mm pipe. Suction pipe work must be UPVC/Polypropylene material. **DO NOT USE ABS PLASTIC PIPE.** Swept bends only to be used. Waste pipes must have a minimum fall of 2% and maintain a flow of 8.5 litres/minute. If possible should allow access for cleaning. **WASTES MUST HAVE A TRAP FITTED IN LINE TO PREVENT UNWANTED ODOURS TRAVELING BACK TO SURGERY. TRAP MUST BE EASILY ACCESSIBLE.** We also request that the contractor installing the pipe work indicates on the actual pipe work which pipe is suction, waste & vent pipe (if applicable).

'WRAS' approved **Double Check Valve** should be fitted in a suitable serviceable position in the water line supplying the dental treatment centre / washer disinfectant.

WHEN ROUTING THE REQUIRED PIPE WORK, PLEASE BE AWARE THAT SUBSTANTIAL FIXING BOLTS MAY BE USED BY WRIGHTS WHEN SECURING THE CHAIR TO THE FLOOR. PLEASE CHECK WITH THE EQUIPMENT MANAGER SO THAT THE PIPE WORK CAN BE RUN TO AVOID THESE POSITIONS.

It is the responsibility of the CUSTOMER / CONTRACTOR to ensure that all structures are capable of withstanding the loads of the equipment to be fitted, and that all building regulation(s) are satisfied.

CABINETS SERVICES:

- #1. Sinks - H&C water in 15mm copper, waste in 40mm plastic.
- #2. Electrical sockets mounted inside the cabinetry. Supply electrics in 2.5 T&E leaving 1000mm tail through floor at each point.

NB: 1st & 2nd fix for the cabinetry services to be undertaken by others. Electrical wall mounted sockets mounted above the cabinetry (Supplied & fitted by others).

SUCTION MOTOR SERVICES:

- #3. Durr VS(A) 300s suction motor - Exhaust to atmosphere, waste outlet, suction pipe, switch wires to chair service position & electric socket in wall at low level. See Dwg. **DUR101A.**

DENTAL CHAIR SERVICES:

- #4. Adec 300RS - Mains cold water, compressed air, electric, suction pipe, media link (may not be required, please check) & electric switch wires from suction motor. See Dwg. **ADE101A.**
- #5. Installation pipe for media link (recommended). Plumber to provide a 40mm ID plastic pipe c/w swept bends and pull through wire. To run between cabinet position as shown to chair foot position leaving a short vertical tail at each end.

X-RAY SERVICES:

- #XR Kavø Focus wall mounted x-ray, xtra long arm.
- #CB Wall mounted x-ray control box / operating switch.
- #FS Wall mounted switched fused spur to isolate & power the x-ray. See Dwg. **KAV106.**

NB: Please see the x-ray note regarding RPA consultation prior to the installation of services.

NB: THIS DRAWING IS TO BE READ IN CONJUNCTION WITH THE ASSOCIATED SHEETS, please consult with your Wrights Equipment Manager if further information is required.

THE CHAIR POSITION / ANGLE MUST BE APPROVED BEFORE COMMENCING WITH THE INSTALLATION OF SERVICES.

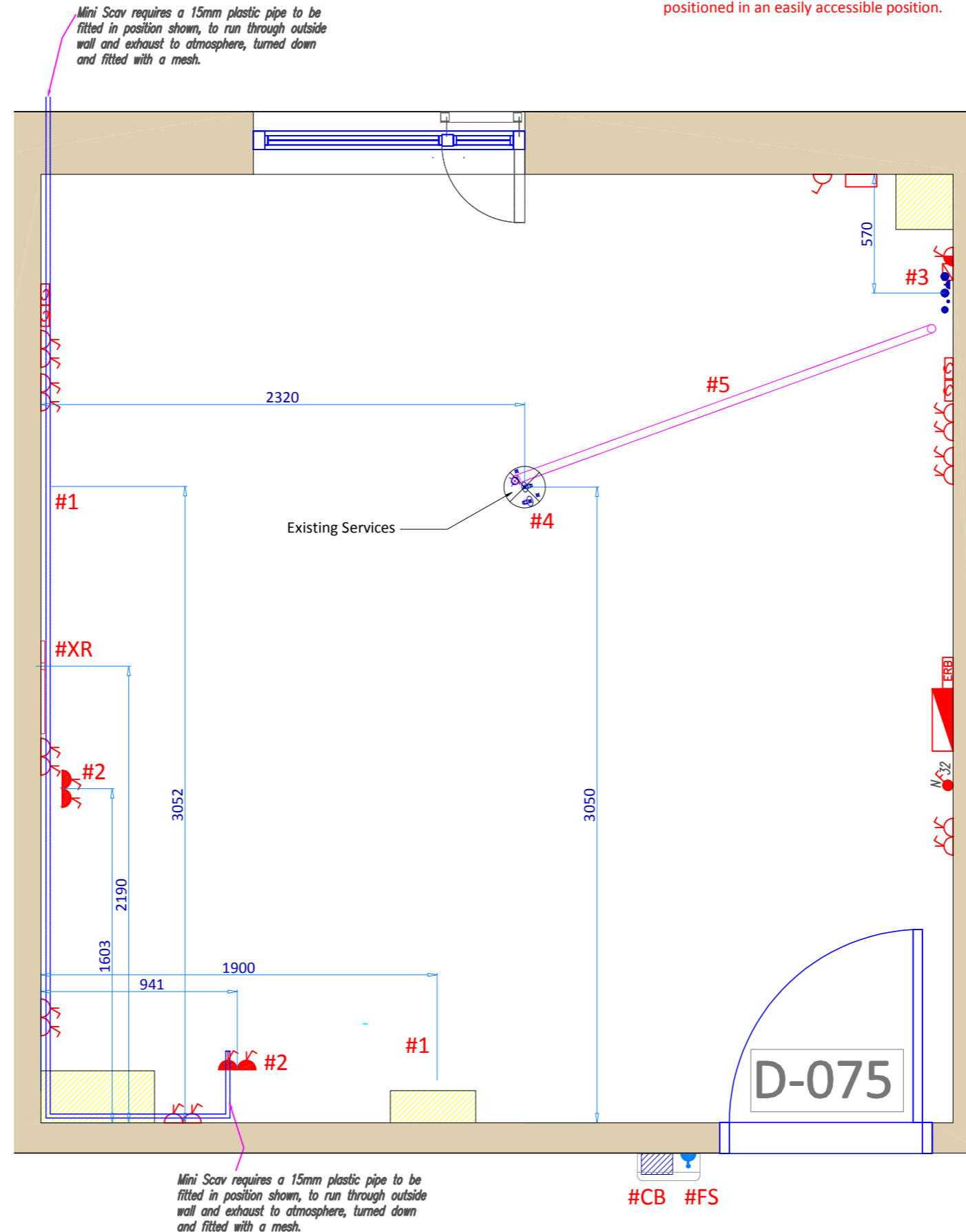

NOTE TO CONTRACTOR: The floor structure must have a minimum loading capacity of 0.5N/cm² (0.7lbs/in²). If in doubt, please consult a structural engineer for advice. (Chair weight of up to approx. 224kgs + patient loading, dental surgeon loading, DS assistant loading and other floor mounted equipment need to be considered)

This drawing remains the property of Wright Health Group Ltd. This drawing is issued on the condition that it is not copied reproduced, retained or disclosed to any unauthorized persons. **DO NOT SCALE. ALL DIMENSIONS TO BE CHECKED ON SITE.**

Revision Details	Date
A - Updated the room sizes.	09.04.19

Customer / Project
NHS Lothian Blackburn Partnership Centre
Equipment Manager
Neil Worrall

Scale	1:25 @ A3
Creation Date	26.03.19
Project No.:	Revision:
WHG2419 D075 SV	A



Layout Plan

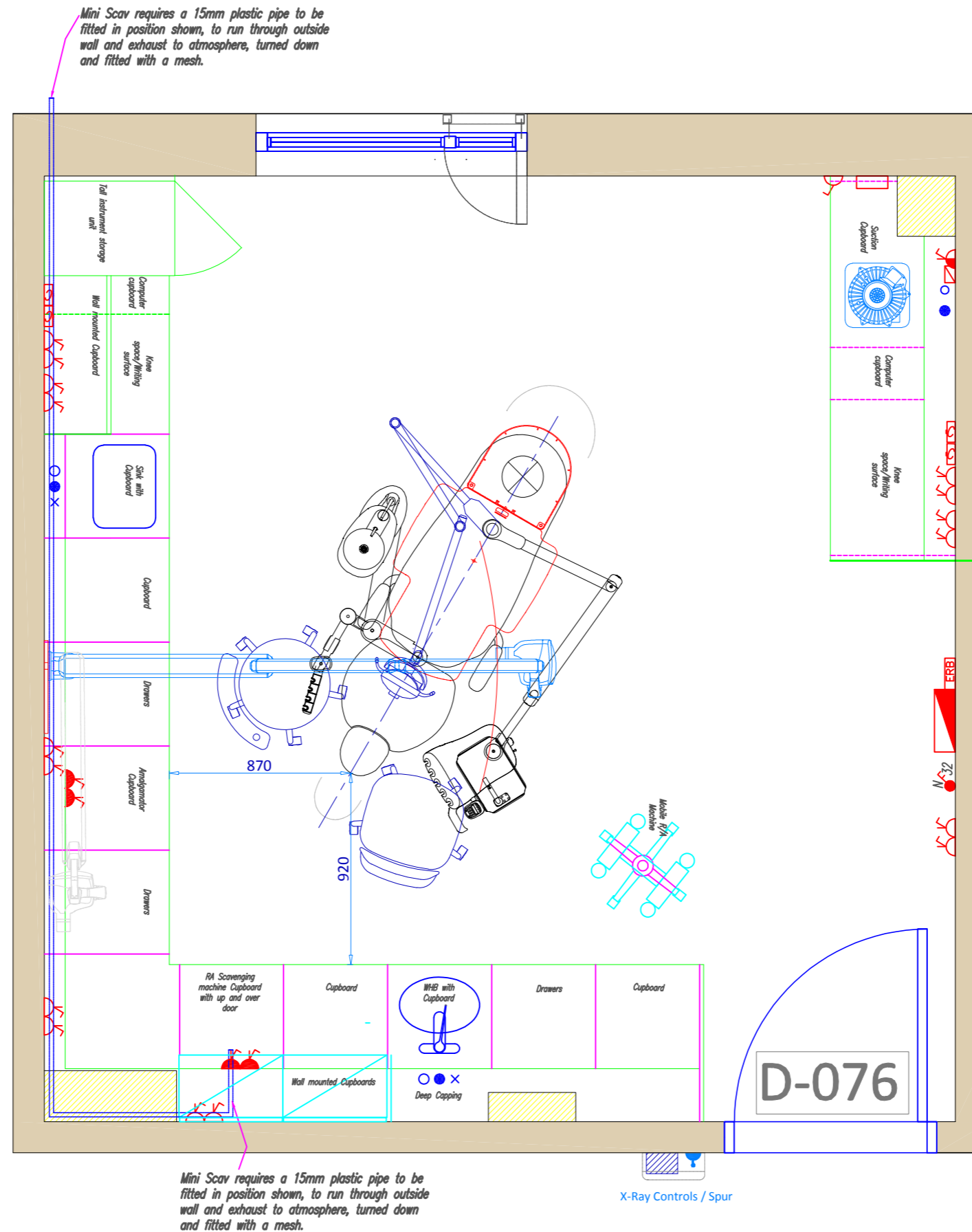

EQUIPMENT INDICATED:

- Adec 300RS Chair Package.
- Durr VSA300s suction motor.
- Kavo Focus wall mounted x-ray, 900mm arm - 2160mm reach.
- Intrafit cabinetry as shown.

Revision Details A - Updated the room sizes.	Date 09.04.19
---	------------------

Customer / Project
NHS Lothian
Blackburn Partnership Centre

Equipment Manager
Neil Worrall

Scale 1:25 @ A3

Creation Date 26.03.19

Project No.: WHG2419 D076	Revision: A
------------------------------	----------------

LAYOUT / POSITIONS APPROVED BY:
DATE: ___/___/___

Customer Name (PRINT)	Customer Signature
-----------------------	--------------------



Service Plan

NOTE: Remember to discuss the position of the isolating valves for the air & water supplies to this room. The valves must be positioned in an easily accessible position.

IMPORTANT NOTES TO CUSTOMER / CONTRACTOR:

CABINETS (if applicable):
The provision of, and connection to, services for sinks, taps and electric sockets within the cabinets would need to be carried out by the appointed PLUMBING AND ELECTRICAL CONTRACTORS. The exact service positions will be annotated on the service drawing provided by Wrights and/or their appointed Cabinetry Supplier. Wrights cannot be held liable if services are positioned incorrectly and cabinetry installations are delayed as a result.

POWER:
When a power supply is less than 1.5mtrs away from a water supply an R.C.D. (residual current device) must be fitted.

ISOLATION:
The mechanical services contractor must ensure that the water and air supplies to each individual surgery can be isolated to enable the dentist to turn off the water & air supplies at the end of surgery hours. These isolation valves must be fitted in an easily accessible position. It is also the responsibility of the mechanical services contractor to supply & fit the relevant parts for this isolation.

COMPRESSED AIR:
The air lines should be run in 15mm copper piping. An air/water separator should be fitted in line at the pipe entry point into the surgery. The pipe should then be lagged from the air/water separator to the pipe termination point. Adequate earth bonding will be required to the floor box. Wrights will not accept any responsibility for inadequate pipe work being used.

SUCTION & WASTE:
All waste & Suction pipe work to be no less than 40mm pipe. Suction pipe work must be UPVC/Polypropylene material. **DO NOT USE ABS PLASTIC PIPE.** Swept bends only to be used. Waste pipes must have a minimum fall of 2% and maintain a flow of 8.5 litres/minute. If possible should allow access for cleaning. **WASTES MUST HAVE A TRAP FITTED IN LINE TO PREVENT UNWANTED ODOURS TRAVELING BACK TO SURGERY. TRAP MUST BE EASILY ACCESSIBLE.** We also request that the contractor installing the pipe work indicates on the actual pipe work which pipe is suction, waste & vent pipe (if applicable).

'WRAS' approved **Double Check Valve** should be fitted in a suitable serviceable position in the water line supplying the dental treatment centre / washer disinfectant.

WHEN ROUTING THE REQUIRED PIPE WORK, PLEASE BE AWARE THAT SUBSTANTIAL FIXING BOLTS MAY BE USED BY WRIGHTS WHEN SECURING THE CHAIR TO THE FLOOR. PLEASE CHECK WITH THE EQUIPMENT MANAGER SO THAT THE PIPE WORK CAN BE RUN TO AVOID THESE POSITIONS.

It is the responsibility of the CUSTOMER / CONTRACTOR to ensure that all structures are capable of withstanding the loads of the equipment to be fitted, and that all building regulation(s) are satisfied.

CABINETS SERVICES:

- #1. Sinks - H&C water in 15mm copper, waste in 40mm plastic.
- #2. Electrical sockets mounted inside the cabinetry. Supply electrics in 2.5 T&E leaving 1000mm tail through floor at each point.

NB: 1st & 2nd fix for the cabinetry services to be undertaken by others. Electrical wall mounted sockets mounted above the cabinetry (Supplied & fitted by others).

SUCTION MOTOR SERVICES:

- #3. Durr VS(A) 300s suction motor - Exhaust to atmosphere, waste outlet, suction pipe, switch wires to chair service position & electric socket in wall at low level. See Dwg. **DUR101A.**

DENTAL CHAIR SERVICES:

- #4. Adec 300RS - Mains cold water, compressed air, electric, suction pipe, media link (may not be required, please check) & electric switch wires from suction motor. See Dwg. **ADE101A.**
- #5. Installation pipe for media link (recommended). Plumber to provide a 40mm ID plastic pipe c/w swept bends and pull through wire. To run between cabinet position as shown to chair foot position leaving a short vertical tail at each end.

X-RAY SERVICES:

- #XR Kavo Focus wall mounted x-ray, xtra long arm.
- #CB Wall mounted x-ray control box / operating switch.
- #FS Wall mounted switched fused spur to isolate & power the x-ray. See Dwg. **KAV106.**

NB: Please see the x-ray note regarding RPA consultation prior to the installation of services.

NB: THIS DRAWING IS TO BE READ IN CONJUNCTION WITH THE ASSOCIATED SHEETS, please consult with your Wrights Equipment Manager if further information is required.

THE CHAIR POSITION / ANGLE MUST BE APPROVED BEFORE COMMENCING WITH THE INSTALLATION OF SERVICES.

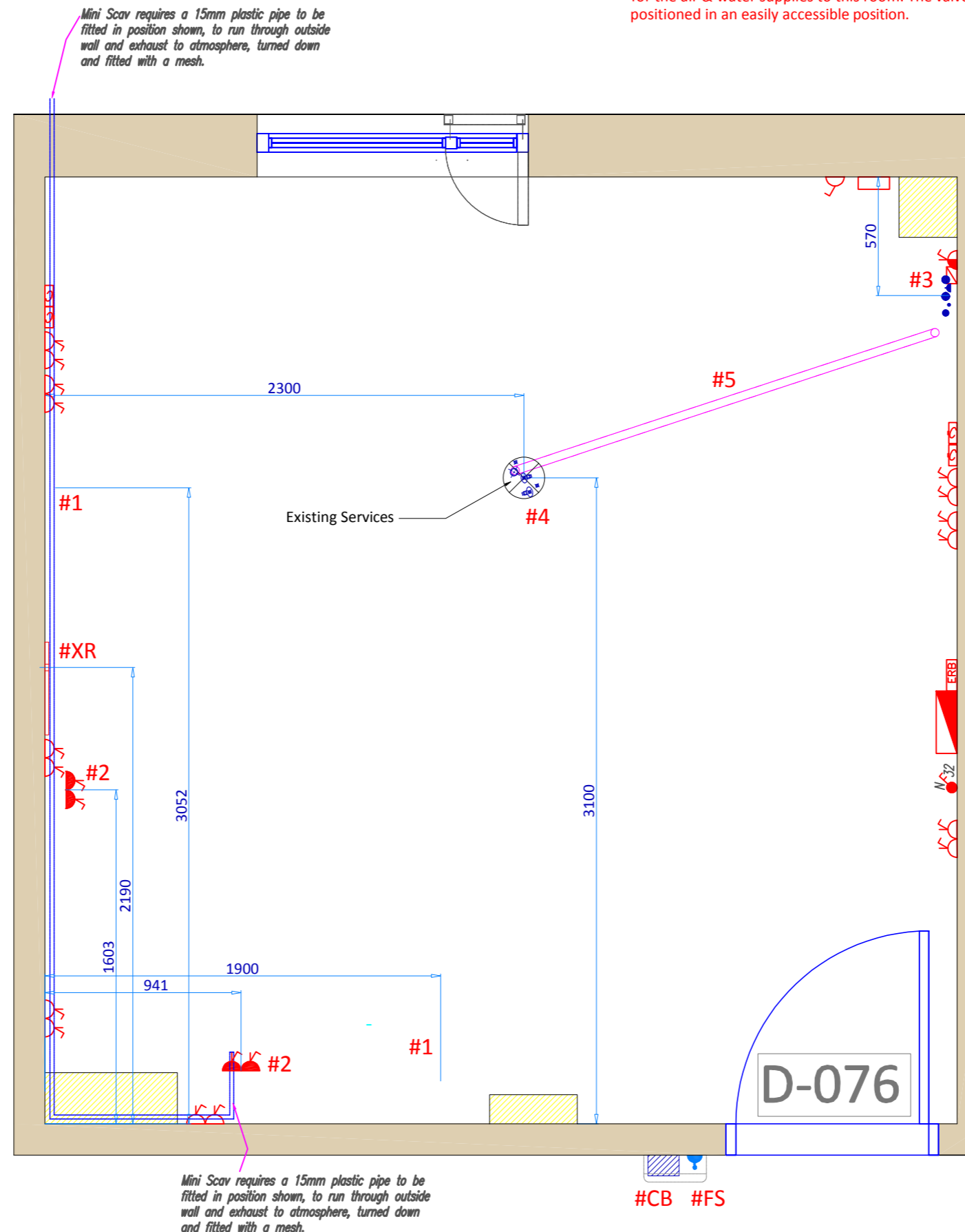

NOTE TO CONTRACTOR: The floor structure must have a minimum loading capacity of 0.5N/cm² (0.7lbs/in²). If in doubt, please consult a structural engineer for advice. (Chair weight of up to approx. 224kgs + patient loading, dental surgeon loading, DS assistant loading and other floor mounted equipment need to be considered)

Revision Details	Date
A - Updated the room sizes.	09.04.19

Customer / Project
NHS Lothian Blackburn Partnership Centre
Equipment Manager Neil Worrall

Scale	1:25 @ A3
Creation Date	26.03.19
Project No.:	Revision:
WHG2419 D076 SV	A



DURR VS(A) 300S SUCTION MOTOR

NOTE: Remember to discuss the position of the isolating valves for the air & water supplies to this room. The valves must be positioned in an easily accessible position.

Scale 1:1

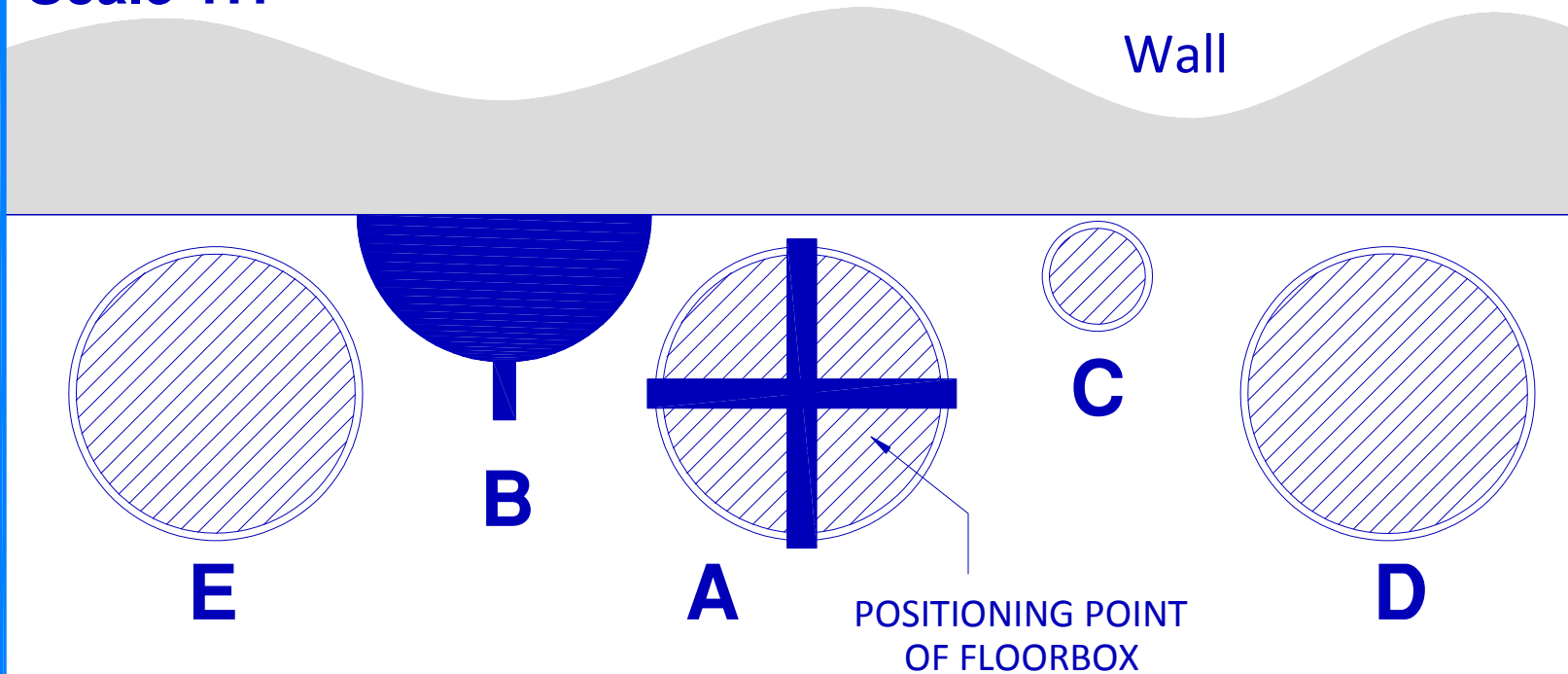

A 40mm WASTE PIPE (UPVC / POLYPROPYLENE MATERIAL) TO GRAVITY DRAIN. WASTE PIPE MUST NOT BE HIGHER THAN 200mm AFFL OR PUMP OUTLET.
DO NOT USE ABS PIPE'S.

B POWER SUPPLY 240V / 13A (SWITCHED PLUG SOCKET @ APPROX 500mm AFFL).

C 1mm 3core SWITCH WIRE FROM CHAIR SERVICES. LEAVE 1mtr TAILS.

D 40mm SUCTION PIPE FROM CHAIR (UPVC / POLYPROPYLENE MATERIAL) **DO NOT USE ABS PIPE'S.** SWEPT BENDS ONLY. ROUTE TO BE DETERMINED ON SITE TO MINIMISE THE NUMBER OF BENDS REQUIRED (LENGTH 6mtr MAX).

E 40mm VENT PIPE TO OUTSIDE ATMOSPHERE. ROUTE TO BE DETERMINED ON SITE.

This drawing remains the property of Wright Health Group Ltd. This drawing is issued on the condition that it is not copied reproduced, retained or disclosed to any unauthorized persons.
DO NOT SCALE. ALL DIMENSIONS TO BE CHECKED ON SITE.

PLEASE DISCUSS & CHECK WITH YOUR WRIGHTS EQUIPMENT MANAGER BEFORE PROCEEDING WITH THE INSTALLATION OF SERVICES.

Drawing No.:

DUR101A

Wrights
THE DENTAL
SUPPLY CO

ADEC 300 / 400 / 500 FLOORBOX (Contoured)

NOTE: Remember to discuss the position of the isolating valves for the air & water supplies to this room. The valves must be positioned in an easily accessible position.

Scale 1:1

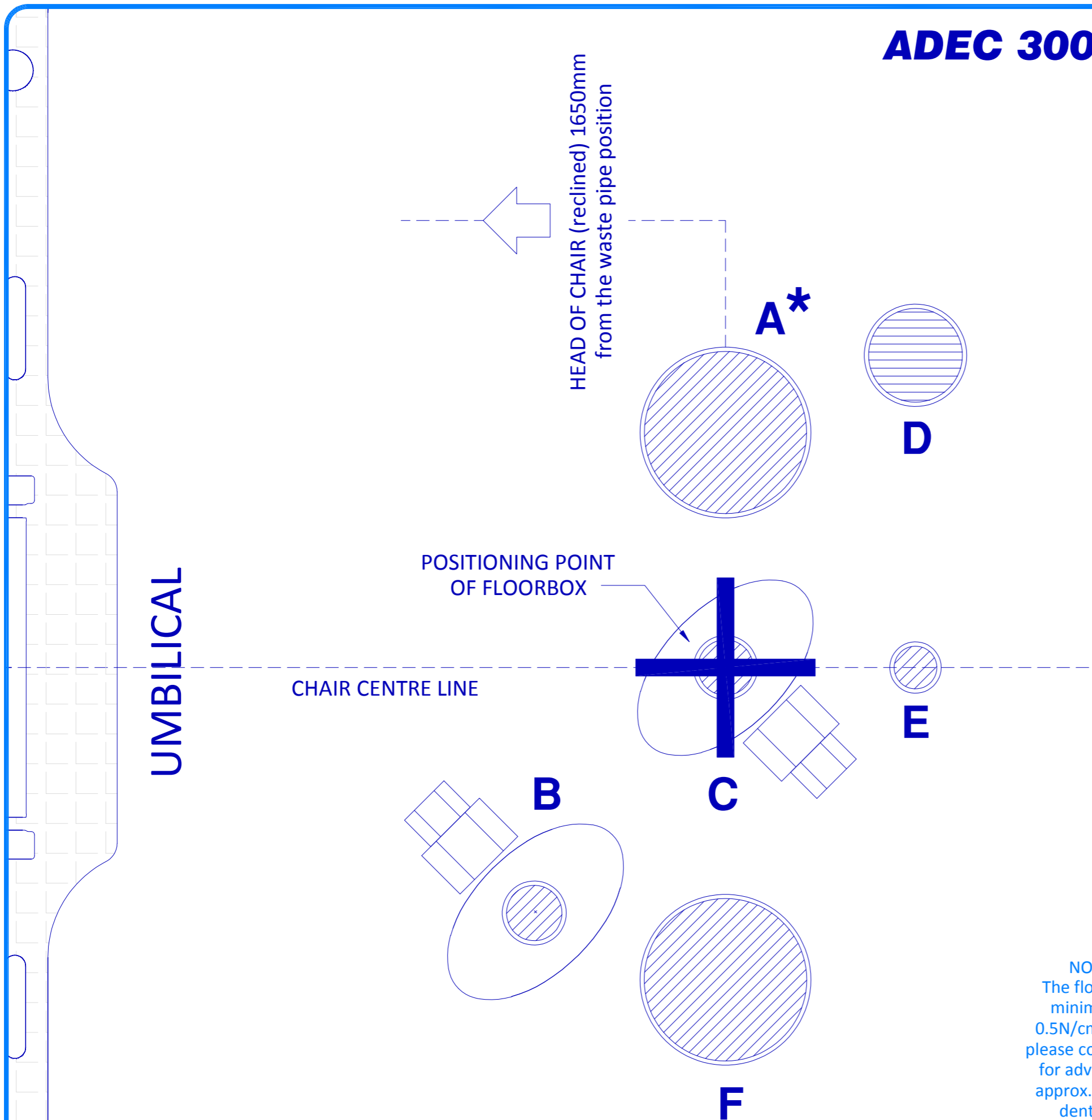

- A 40mm MEDIA PIPE DUCT TO RUN BACK TO THE CABINERY. SWEPT BENDS ONLY. x2 PULL THROUGH WIRES TO BE LEFT (OPTIONAL WASTE PIPE PLEASE CHECK).
- B 15mm COPPER PIPE (AIR SUPPLY FROM COMPRESSOR) MUST HAVE BALL-O-FIX ISOLATION VALVE FITTED. TERMINATED NO MORE THAN 80mm AFFL.
- C 15mm COPPER PIPE (WATER SUPPLY) MUST HAVE BALL-O-FIX ISOLATION VALVE FITTED. TERMINATED NO MORE THAN 80mm AFFL.
- D TWIN 13amp SOCKET IN SURFACE BOX (IP66) ON FLYING LEAD. SWITCHED FUSE SPUR LOCATION TBC ON SITE.
- E SUCTION PUMP CONTROL WIRE IN CONDUIT. 3core SWITCH WIRE FROM SUCTION MOTOR. LEAVE 0.5mtr TAILS. TERMINATE CONDUIT 30mm AFFL.
- F 40mm SUCTION PIPE (UPVC / POLYPROPYLENE MATERIAL) FROM SUCTION MOTOR. TERMINATE WITH 40mm SOCKET FLUSH TO FLOOR LEVEL, NOT BELOW. SWEPT BENDS ONLY TO BE USED.

PLEASE DISCUSS & CHECK WITH YOUR WRIGHTS EQUIPMENT MANAGER BEFORE PROCEEDING WITH THE INSTALLATION OF SERVICES.

NOTE TO CONTRACTOR:
The floor structure must have a minimum loading capacity of 0.5N/cm² (0.7lbs/in²). If in doubt, please consult a structural engineer for advice.(Chair weight of up to approx. 224kgs + patient loading, dental surgeon loading, DS assistant loading and other floor mounted equipment need to be considered)

Drawing No.:

ADE101A



KAVO FOCUS INTRAORAL WALL MTD. X-RAY

Scale 1:20

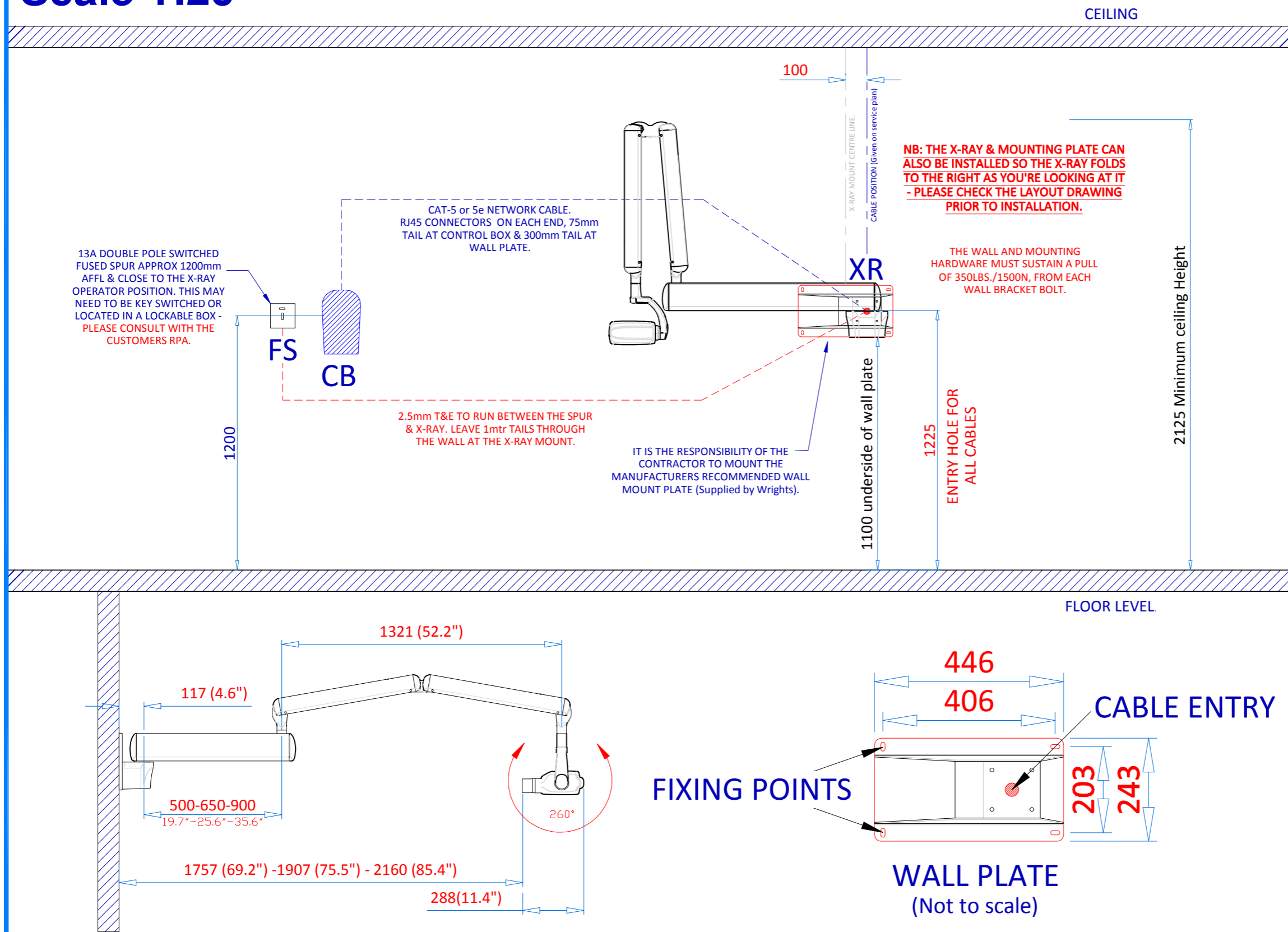

Drawing No.:

KAV106

Wrights
THE DENTAL
SUPPLY CO

NOTE: Any indications given in respect of radiation protection, the siting of x-ray equipment and / or x-ray controls is for guidance purposes only. It is for your appointed RPA to review the environment in which the x-ray machine is to operate and to ensure your compliance under IRR99. This drawing should not be used as the basis for any design, construction work or the provisioning of services involving x-ray equipment without the approval of your RPA.

This drawing remains the property of Wright Health Group Ltd. This drawing is issued on the condition that it is not copied, reproduced, retained or disclosed to any unauthorized persons. DO NOT SCALE. ALL DIMENSIONS TO BE CHECKED ON SITE.